

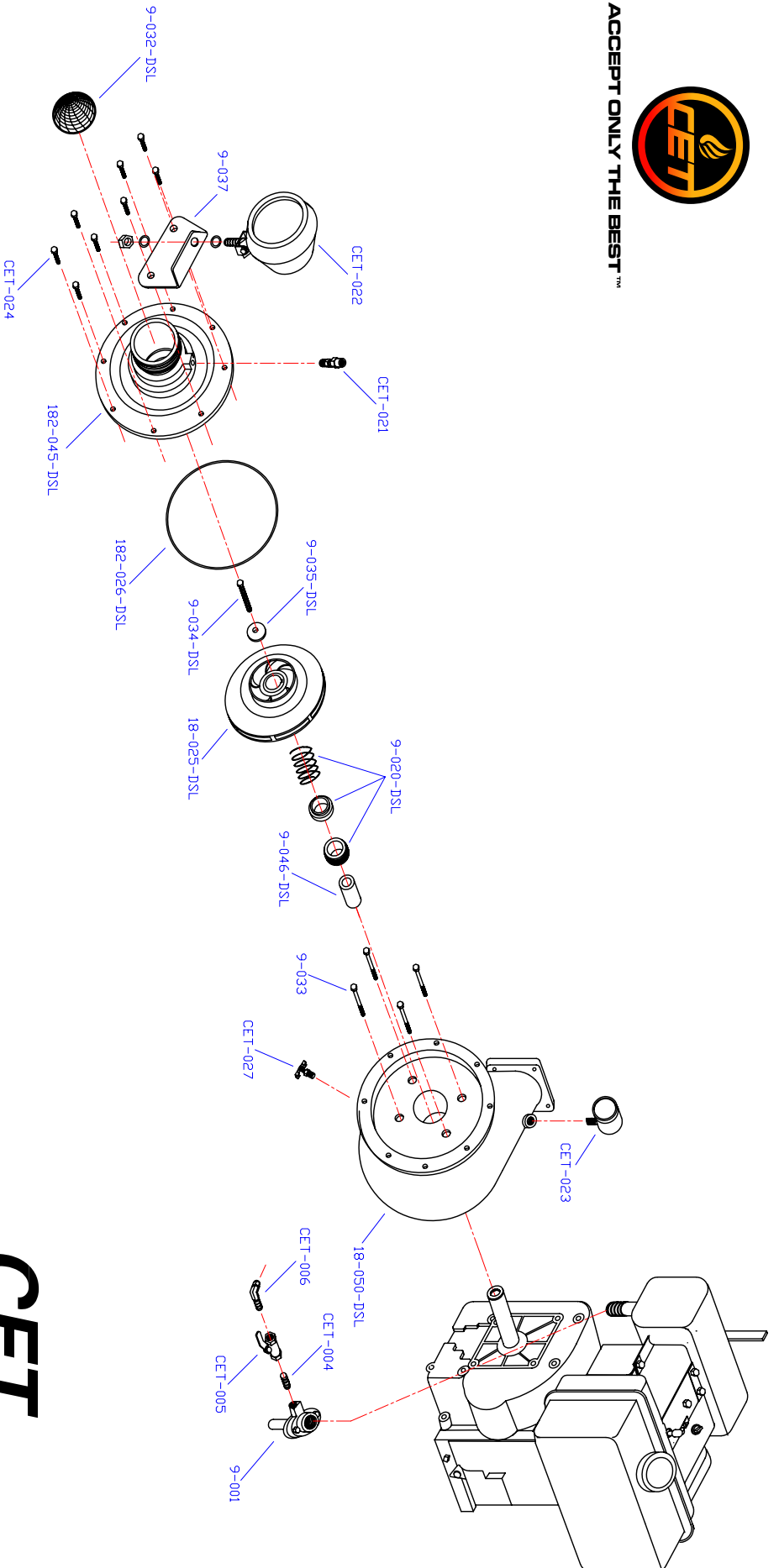

ACCEPT ONLY THE BEST™



# CET

## FIRE PUMPS MFG

### PFP-9hp-DSL

Dessins/Pompe/Assembla/9hnd-dsl

<b>CET</b>		<b>ASSEMBLY</b>	
<b>FIRE PUMPS MFG</b>		<b>PFP-9hp-DSL</b>	
PROJET:			
CONTRAT NO:	DRAWING NO:	DATE:	REVISIONS
NO	DESSIN	10/11/1997	01
		DATE	DATE
DRAW:	VERIFY:	SCALE:	DATE
MR	NOM	N.S.	02
			03
		DATE	DATE

75 Hector St., P.O. Box 90, Pierreville (Québec) Canada J0G 1J0 | Telephone: 1-800-567-2719 | Fax: 1-800-434-2613 | [www.fire-pump.com](http://www.fire-pump.com)

A CENTURY OF ENGINEERING FOR THE BRAVEST

\*CET is a trademark of CET Fire Pumps Mfg Ltd.

**CET  
FIRE PUMPS MFG  
PFP-9hp-DSL Yanmar**

**PARTS LIST**

**PFP-9hp-DSL**

PART NUMBER	DESCRIPTION	QTY
10-052	Screen	1
CET-024	Bolt	8
10-051-DSL	Switch bracket	1
10-037	Spotlight bracket	1
CET-022	Spotlight	1
10-045-DSL	Pump cover	1
CET-021	Brass coupling	1
10-036DSL ( rev.2)	Water ring	1
CET-025	O`ring	1
CET-035	Bolt	1
10-035	Cap	1
10-025-DSL	Impeller	1
CET-020	Seal kit	1
10-046DSL	Bushing	1
10-047DSL ( rev.2)	Water ring ( casing)	1
CET-033	Bolt	1
CET-097	Fitting	1
10-050-DSL	Casing	1
CET-023	Pressure gauge	1
CET-048	Seal kit	1
CET-047	Valve	1
CET-054	Handle valve	1
CET-049	Flange	1
CET-057	Bolt	4
CET-182	Throttle	1
11-002	Venturi	1
CET-004	Close nipple	1
CET-005	Ball valve	1
CET-006	Fitting	1
		5/05/04 (rev.3)
PART NUMBER	DESCRIPTION	QTY

